

PROSPETTO SUD scala 1:50

PROSPETTO NORD scala 1:50

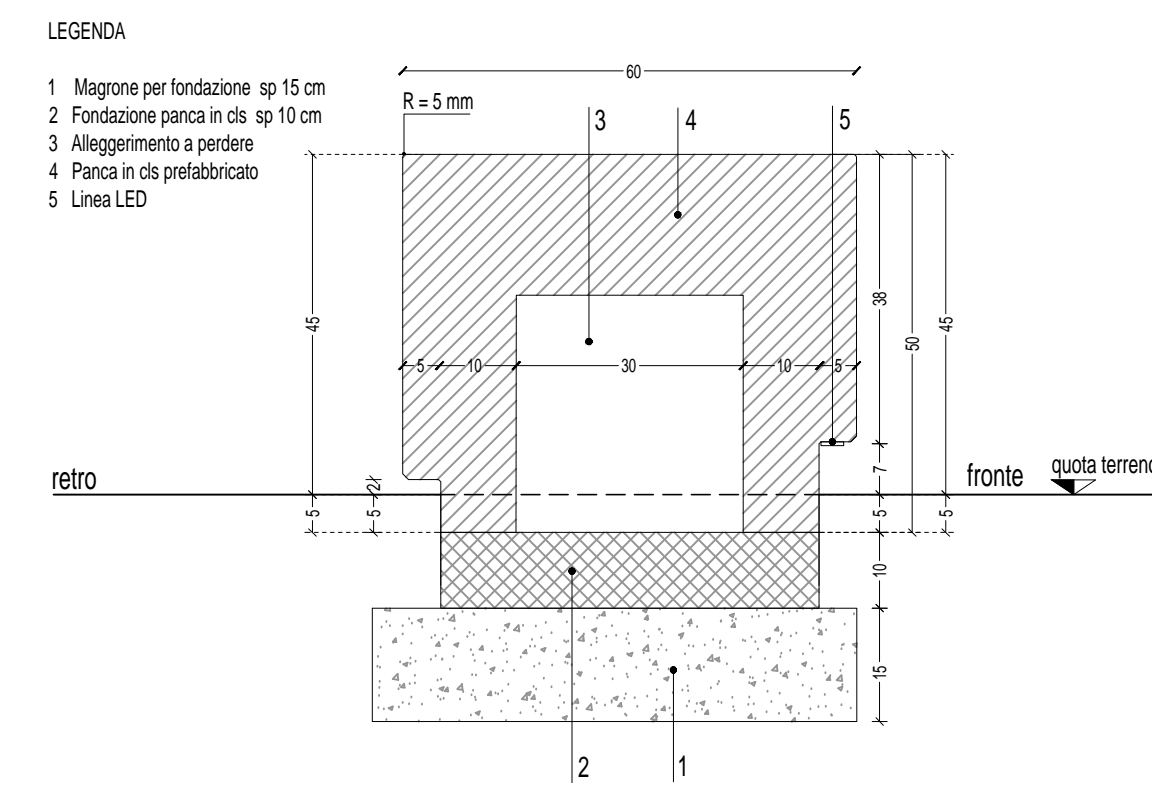

Sezione panca scala 1:10

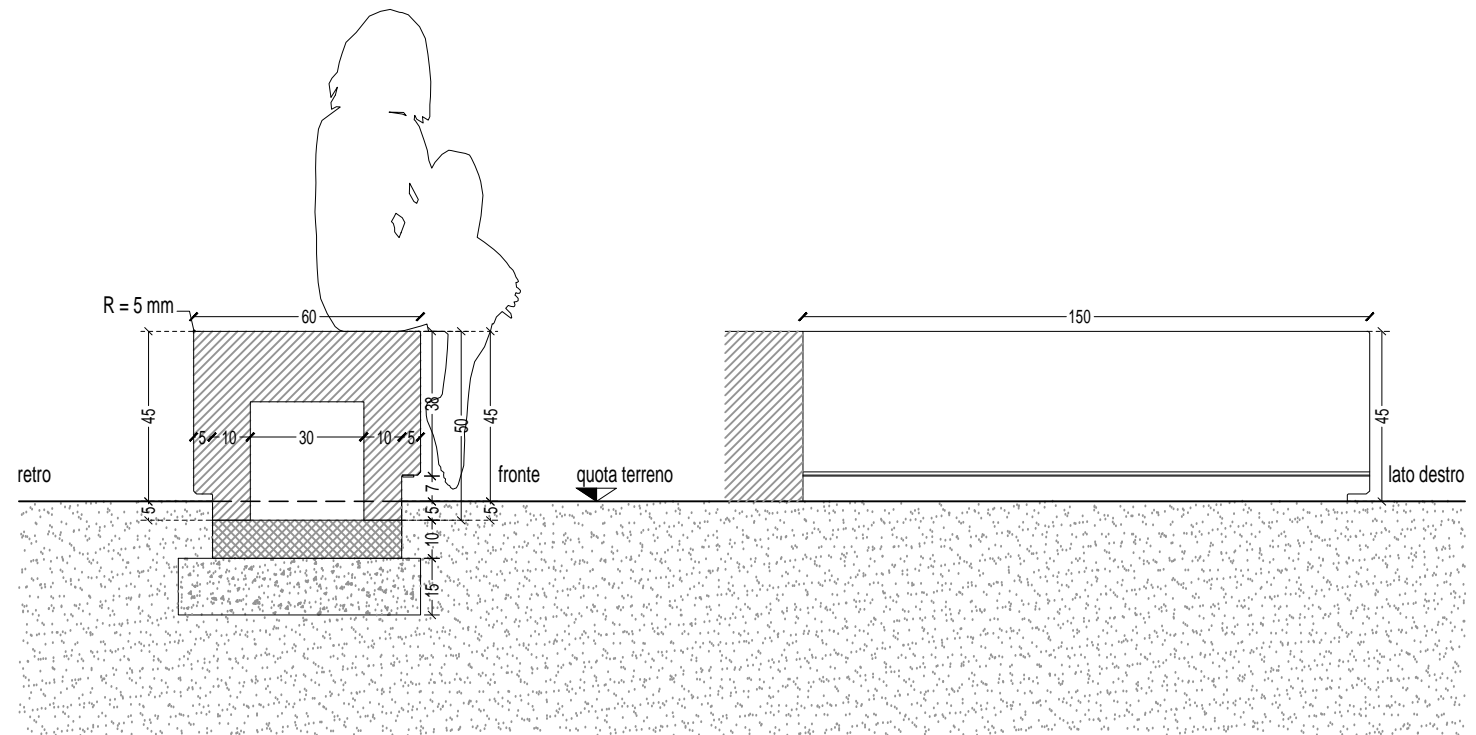

Sezione panca scala 1:20

Prospetto frontale modulo destro scala 1:20

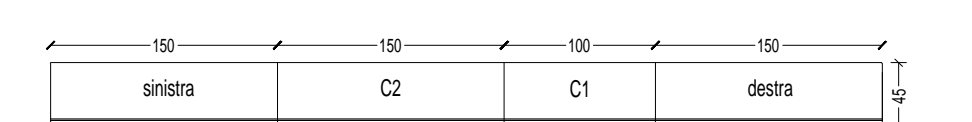

Prospetto frontale

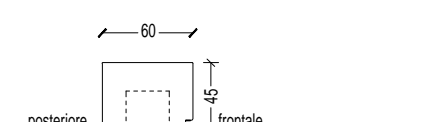

Prospetto laterale sinistro

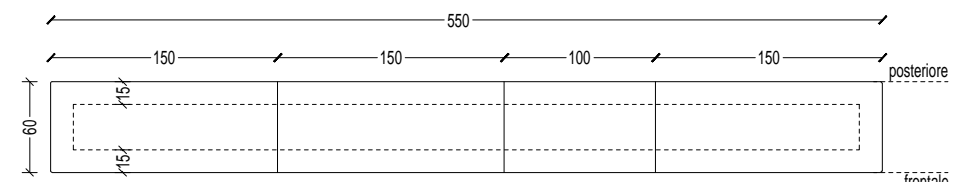

Pianta panca in cls 550 x 60 cm scala 1:50

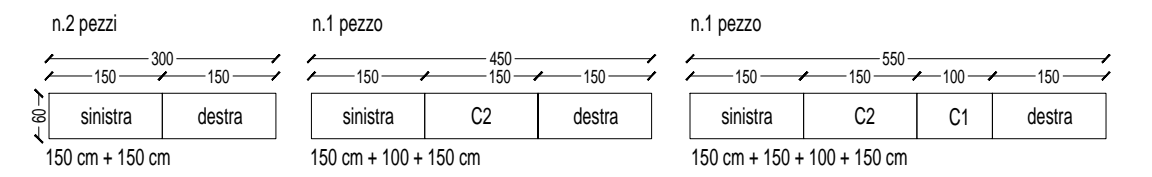

Abaco moduli panche scala 1:100

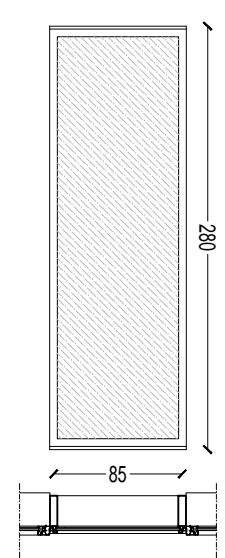

SE | S.01
Serramento
telaio fisso in
alluminio

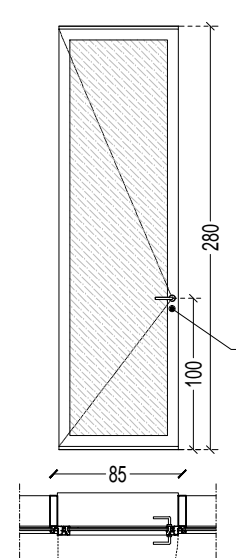

SE | S.02
Serramento a battente
in alluminio

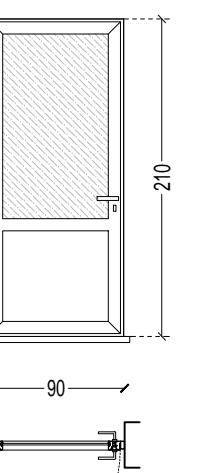

SE | S.05
Terramento esterno in
alluminio con
lamponature e finitura
come esistente su lato
opposto bagni

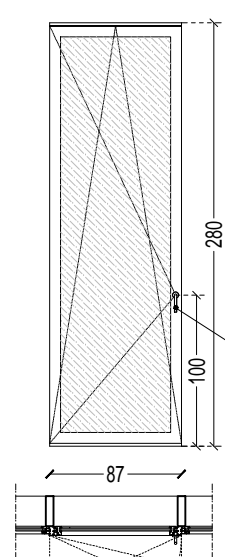

SE | S.03
Serramento a battente
in alluminio + vasistas
+ cerniera a compasso

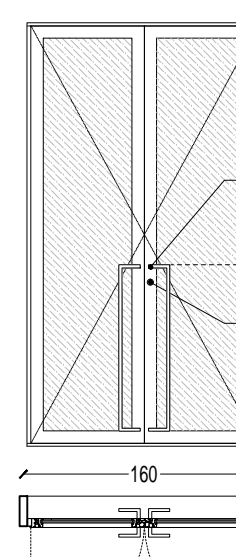

SE | S.04
Serramento ingresso
a battente in alluminio

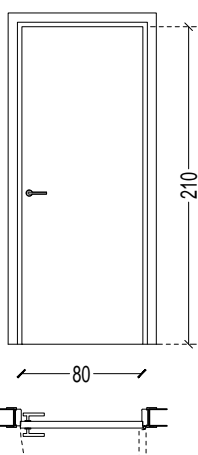

SI | S.01
Serramento a battenti
interno finitura bianca
da campionare

ABACO SERRAMENTI scala 1:50



A. 1.4.L

1. Riqualficazione urbana e territoriale degli ambiti delle stazioni M2 lungo l'asta della Martesana



COMUNE DI VIMODRONE

RIQUALIFICAZIONE AREA A VERDE DENOMINATA
"GIARDINO CASCINA 3 FONTANILI"

PROGETTO ESECUTIVO

Volume bar. Tracciamento Pianta sezioni prospetti. Abaco serramenti

Responsabile del Procedimento:
Ing. Christian Leone

Progettista:
Arch. Emilio Caravatti
con arch. Sergio Fumagalli, Elena Verri, Riccardo Miccoli

DATA 15.12.2017

scala 1:50 - 1:20 - 1:10

TAV.N. A1.03

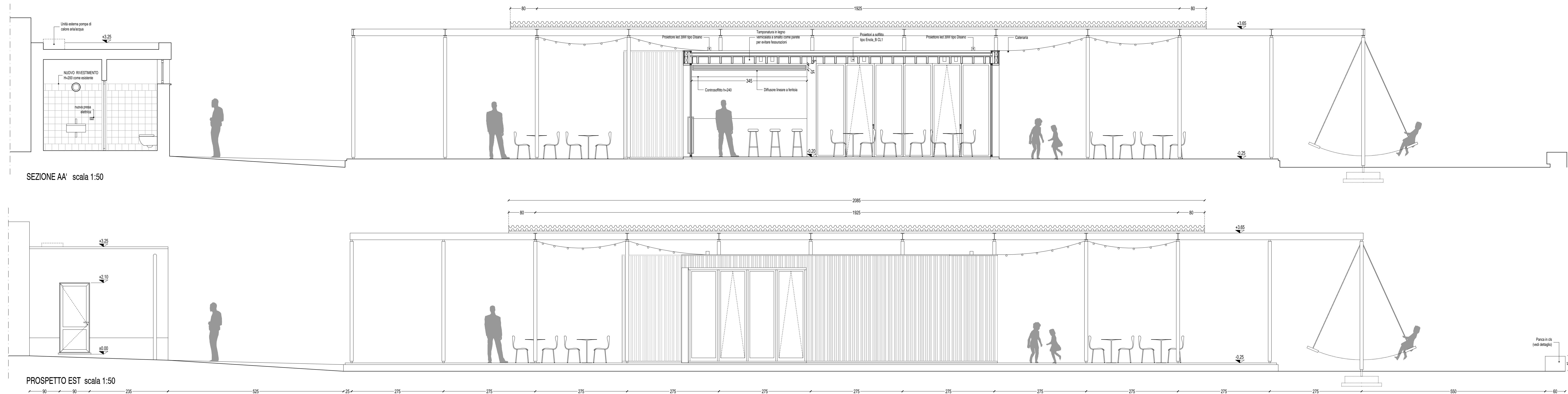

PROSPETTO EST scala 1:50

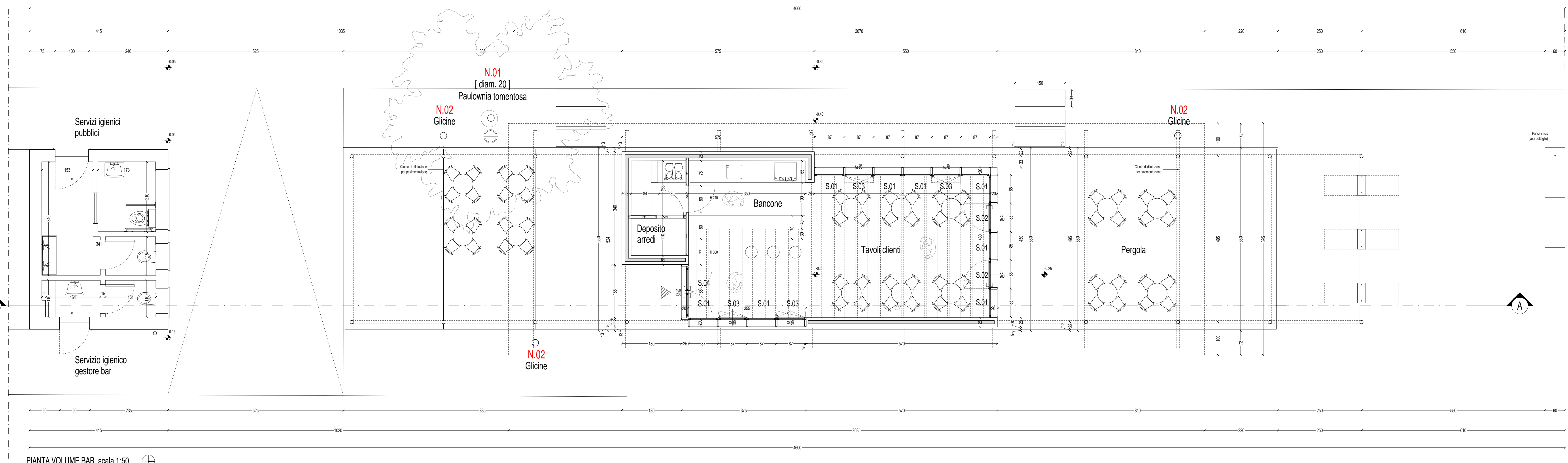

PIANTA VOLUME BAR scala 1:50